



# FAG

## Technical parameters

GB 3836.1、GB 3836.2、IEC60079				Implementation standard
Exd II BT4				Ex mark
<b>AC220 volt - 1 phase - 50/60 hertz or 400 / 440 volt - 3 phase - 50 / 60 hertz</b>				
0.18kW	0.37 kW	0.55 kW	0.75 kW	Rated power
300mm	400mm	500mm	600mm	Fan blade diameter
2280m <sup>3</sup> /h	2880 m <sup>3</sup> /h	5700 m <sup>3</sup> /h	8700 m <sup>3</sup> /h	Air volume
1450 r/min				Spindle speed
WF1				Grade of corrosion proof
G3/4"				Intakes specification
Φ9mm ~ Φ14mm				Applicable cable diameter

## Outline and mounting dimensions

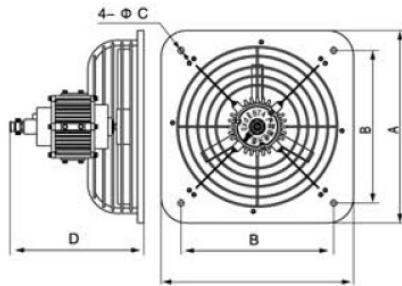

FAG -300、FAG-400

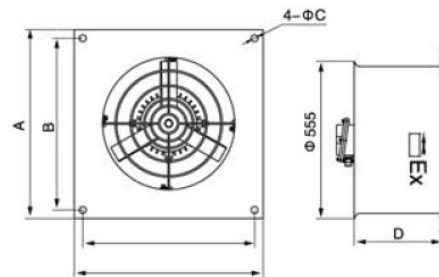

FAG -500

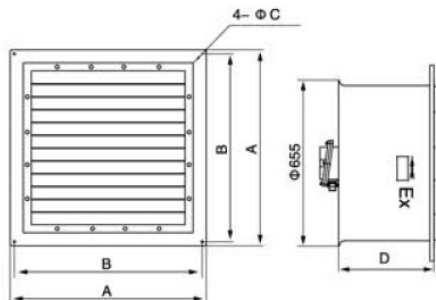

FAG -600

Model number	Dimension (mm)			
型号	外形尺寸(mm)			
	A	B	C	D
FAG -300	395	350	8.5	345
FAG -400	480	384	8.5	375
FAG -500	500	600	8.5	280
FAG -600	600	700	8.5	280